

**Section R – GEARBOX (SYNCHROMESH)**

**REFER TO THE SCHEDULES OF SPARE PARTS  
FOR  
SILVER DAWN E SERIES on  
AND  
BENTLEY 'R' TYPE**

S I L V E R D A W N

'E' SERIES ONWARDS.

SECTION G.

GEARBOX.

CONTAINING:-

GROUP 1.	CHANGE SPEED MECHANISM (R.C. ONLY)
" 1.A.	CHANGE SPEED MECHANISM (STEERING COLUMN SYNCHROMESH)
" 1.B.	CHANGE SPEED MECHANISM (AUTOMATIC) to SRH-70.
" 1.C.	CHANGE SPEED MECHANISM (AUTOMATIC) (RC)
" 1.D.	CHANGE SPEED MECHANISM (AUTOMATIC) (LC) SRH-72 ON.
" 2.	DAMPER CONTROL PUMP AND SPEEDOMETER DRIVE (SYNCHROMESH)
" 3.	FIRST MOTION SHAFT (SYNCHROMESH)
" 4.	GEARBOX (SYNCHROMESH)
" 4.A.	GEARBOX (AUTOMATIC )
" 5.	REVERSE MOTION SHAFT (SYNCHROMESH)
" 6.	SECOND MOTION SHAFT (SYNCHROMESH)
" 7.	SELECTOR MECHANISM (SYNCHROMESH)
" 8.	SERVO MOTOR DRIVE (SYNCHROMESH)
" 9.	THIRD MOTION SHAFT (SYNCHROMESH)
" 10.	TIE BAR, REFER TO AUTOMATIC GEARBOX SCHEDULE SECTION J.

KEY TO CHASSIS NOTES:

Used on	'E' Series	
Used on SMF	2 - 52	= H.
Used on SMF	54 and onwards	= J.
Used on	E & F Series	
Used on SOG	All chassis	
Used on GFG	1 - 43	= T.
Used on S.P.G.	45 and onwards	= U.

KEY TO CHASSIS NOTES (Cont'd)

Used on	E & F Series (Automatic Gearbox)	
Used on SOG	All Chassis (Automatic Gearbox)	
Used on SPG	1 - 63 (Automatic Gearbox)	= V.
Used on SPG	65 onwards on Automatic Gearbox	= W.

SCHEDULE OF SPARE PARTS

REF. NO. PART NO. QUANTITY NOTES  
GROUP ASS'LY

GROUP G.1. CHANGE SPEED MECHANISM (R.C. SYNCHROMESH)

Comprising:-

BEARING, lateral ball, assembly, including 16 balls .187" dia. RG.6209	1	GB.4155A	1	
BEARING, spherical joint	2	GB.3647	1	
BEARING, spherical, inner, female	3	RG.3225	1	
BEARING, spherical, outer, female	4	RG.3224	1	
BEARING, spherical, male	5	GB.3644	1	
BEARING, upper, shell		RG.8267	1	*
BOLT, 2 BA spherical joint	X.4	KB.7956	4	
BOLT, .312" dia. selector lever	X.11	K.310	1	
BOLT, .375" dia. gate to bracket, retaining	X.12	K.406	2	
BRACKET, assembly, with 2 off stud, KB.405/2	6	RG.3324A	1	
BRACKET, support assembly		RG.8264	1	*
COVER, end	7	RG.3326	1	
COVER, and spherical housing assembly		RG.6283	1	*
COVER, spherical bearing	8	GB.3643	1	
FERRULE, change speed shaft	9	RG.3337	1	
GATE, assembly with stop plate (not supplied separately)	10	RG.3341	1	
JOINT, spherical bearing to gearbox	11	GB.4124	1	
KEY, change speed and selector lever boss, .125" wide (see section X for extra width keys)	X.18	KC.505	2	
LEVER, change speed assembly.	12	RG.5748A	1	H
Arm, reverse stop		GW.1784	2	
Bolt, 5 BA, reverse stop spring, retaining		GB.4154	1	
Bolt, .312" dia., lever boss		K.313	1	
Bush, reverse catch		GB.4152	1	
Handle		GB.992	1	
Lever		RG.5748	1	
Link, spring		GB.4157	1	
Nut, full 5 BA, reverse stop spring, retaining		K.4003	1	
Nut, full, .312" dia., lever boss		K.4009	1	
Piece, distance, reverse stop and fulcrum		GB.4153	2	
Rod, with sleeve GW.1464 and sleeve pin RG.3340 assembled		RG.5746	1	
Spring, inside handle		G.84203	1	
Spring, reverse stop		GW.1782	1	
Stop, reverse		RG.3338	1	
Stop, sleeve		GB.843	1	
Washer, spring, .3125" dia. lever boss		K.9009	1	

## SCHEDULE OF SPARE PARTS

REF. NO. PART NO.

QUANTITY  
GROUP ASSY LY

NOTES

## GROUP G.1. CHANGE SPEED MECHANISM (R.C. SYNCHROMESH) (Cont'd)

LEVER, change, speed assembly, as above, except Rod, with sleeve GW.1464 and pin RG.3340 assembled		RG.8317	1	J
		RG.8325	1	
LEVER, change speed assembly,		RG.8475A	1	
Bolt, .312" dia. lever boss		K.312/Z	1	
Bracket, reverse stop		RG.8528	1	
Handle		GB.992	1	
Hub		RG.6280	1	
Lever		RG.8475	1	
Nut, full .312" dia. lever boss		K.4009	1	
Pin, sleeve		RG.3340	1	
Rod, push		RG.8494	1	
Screw, 2 BA bracket		K.1910/Z	2	
Sleeve		GW.1464	1	
Spring, inside handle		G.84203	1	
Stop, reverse centre gear change		RG.8527	1	
Stop, sleeve		GB.843	1	
Washer, plain, 2 BA bracket		K.4404/Z	2	
Washer, spring .3125" dia. lever boss		K.9009	1	
LEVER, selector	13	GB.5129	1	
LEVER, selector		RG.6340	1	*
MEMBER, driven, spherical joint	14	GB.3642	1	
NUT, half, 2 BA, spherical joint	X.24	K.4307	4	
NUT, half, .3125" dia. bracket to frame studs	X.24	K.4313	2	
NUT, half, .3125" dia., selector lever bolt	X.24	K.4313	1	
NUT, full, .3125" dia., selector lever bolt		K.4009/Z	1	*
NUT, half, .375" dia. gate to bracket bolt	X.24	K.4316	2	
NUT, full, bracket to frame		K.4008/Z	4	*
PACKING, bracket to frame	15	RG.3331	4	
RACE, outer, lateral ball bearing	16	RG.3334	1	
RING, spring, change speed shaft	25	RG.3336	1	
SCREW, 2 BA, end cover, retaining	X.46	K.1907/Z	4	
SCREW, hex.head, .250" dia., spherical bearing	X.55	KC.208/Z	3	
SCREW, set, upper bearing to lower bearing		KC.907/Z	2	*
SCREW, set, bracket to frame and cover top		KC.904/Z	6	*
SHAFT, change speed	17	RG.3329	1	
SHAFT, selector, assembly with 1 off Spring, Stop Ring GW.1273	18	GB.4938A	1	
SHAFT, selector, assembly with 1 off spring stop ring GW.1273		RG.6284	1	*
SPRING, change speed shaft	19	RG.3335	2	
SPRING, selector shaft	20	GB.3882	1	
SPRING, selector shaft		RG.6317		*
SPRING, spherical joint	21	GB.1767	1	
STOP, lever		RG.8492	1	*
STOP, rubber	22	RG.3332	1	

G2/12/54.

## SCHEDULE OF SPARE PARTS

REF. NO. PART NO. QUANTITY  
GROUP ASS'Y NOTES

## GROUP G.1. CHANGE SPEED MECHANISM (Continued)

WASHER, change speed shaft	23	RG. 3489	1	
WASHER, end, lateral ball bearing	24	RG. 3333	2	
WASHER, lock, .3125" dia., selector lever bolt	X.89	KB. 7107	1	
WASHER, spring 2 BA end cover screw	X.87	K. 9006	4	
WASHER, spring 2 BA, spherical joint	X.87	K. 9006	4	
WASHER, spring .250" dia. spherical bearing	X.87	K. 9008	3	
WASHER, spring .312" dia. bracket to frame studs	X.87	K. 9009	2	
WASHER, spring, .312" dia., selector lever		K. 9009/Z	1	*
WASHER, spring .375" dia., gate to bracket bolt	X.87	K. 9010	2	
WASHER, spring, bracket to frame (4)		K. 9008/Z	4	*

NOTE: \* These parts are used when centre gear change is fitted.

## GROUP G.1.A. CHANGE MECHANISM TO SUIT L.H. CONTROL (SYNCHROMESH)

Comprising:-

BEARING, flexible, pin strap	1	RG. 5085	2	
BRACKET, bellcrank lever, with 2 off stud KB. 657/Z	2	RF. 6529	1	
BUSH, anti-rattle, centre tube	3	RF. 5032	2	
BUSH, clamping, control linkage	4	RG. 5763	1	
COTTER, lever	5	RG. 5726	2	
COTTER, lever	X.16	KB. 7705	2	
COVER, ball joint, linkage	6	RG. 6768	5	
COVER, dust, change gear tube	7	RF. 6516	1	
COVER, change gear lever	8	RF. 6709	1	
FORK, selector lever to rod	9	RG. 5745	1	
HOUSING, bearing, lower assembly	10	RF. 7155A	1	
Bush, oilite		RF. 6525	1	
Dowel		RF. 6519	1	
Washer, felt		RF. 7152	1	
HOUSING, bearing upper assembly	11	RF. 7368	1	
Bush, oilite		RF. 6520	1	
Housing		RF. 7367	1	
JAW, pull rod	X.17	KB. 1115/Z	3	
JAW, pull rod, selector mechanism	12	GW. 2137	1	
LEVER, bellcrank, gear change mechanism assembly, with 2 off bush GB. 3615	13	RG. 5777	1	
LEVER, bellcrank, gear change mechanism assembly, with 1 off bush GB. 3615	14	RG. 5778	1	

G3/12/54.

## SCHEDULE OF SPARE PARTS

REF. NO. PART NO.

QUANTITY  
GROUP ASS'LY

NOTES

## GROUP G.1.A. CHANGE MECHANISM TO SUIT L.H. CONTROL (Cont'd)

LEVER, gear change tube with bush RF.6501	15	RF.6502	1	
LEVER, gear change assembly, consisting of	16	RF.6993	1	
Bush, oilite		RF.6976	1	
Button, plunger		RF.6508	1	
Handle, gear change lever		RF.6277	1	
Lever		RF.6506	1	
Pin, ball		RF.6515	1	
Rod		RF.6974	1	
Spring		RF.8080	1	
Stop		RF.6975	1	
Washer, lock		RG.4001	1	
LEVER, outer, selector shaft in gearbox	17	RG.5732	1	
LEVER, reverse light operating	18	RG.5735	1	
LEVER, reverse light operating internal assembly consisting of:-	19	RG.5741	1	
Lever		RG.5734	1	
Pad		RG.5727	1	
LEVER, selector with dowel RG.6139 2 off	20	RG.5733A	1	
LEVER, selector assembly, consisting of	21	RF.6548	1	
Bush, oilite		GB.3615	2	
Bush, rubber		RF.6501	1	
Lever		RF.6495	1	
Pin, ball		RF.6515	1	
Washer		RG.4001	1	
LOCKPLATE, selector lever to shaft	22	RG.5742	1	
NUT, lock .250" dia., cotter pin, lever	X.24	K.4310/Z	2	
NUT, lock .250" dia., bearing housing	X.24	K.4310/Z	2	
NUT, lock .250" dia., pin strap	X.24	K.4310/Z	2	
NUT, lock .250" dia., shaft bellcrank lever	X.24	K.4310/Z	2	
NUT, lock, 2 BA cotter lever	X.24	K.4307/Z	2	
NUT, lock, 2 BA	X.24	K.4307/Z	3	
NUT, lock .312" dia.	X.24	K.4313/Z	8	
NUT, plain 2 BA bellcrank lever bracket	X.21	K.4006/Z	2	
PAD, ball pin	23	RF.6514	2	
PIN, strap, bearing housing lower	25	RF.5743	1	
PIN, ball joint housing	26	RG.6770	5	
PIN, plain, .187" dia., pull rod	X.30	KB.4507/Z	3	
PIN, plain, .312" dia. pull rod	X.30	KB.4562/Z	1	
PIN, split, .062" dia.	X.31	K.4602/Z	3	
PIN, split, .062" dia. jaws	X.31	K.4601/Z	3	
PIN, split, .125" dia. jaws	X.31	K.4643/Z	1	
PLUG, ball joint housing	27	RG.6769	5	
PLUG, ball pin	28	RF.6513	2	
ROD, pull lever to gearbox	29	RG.5771	1	

## SCHEDULE OF SPARE PARTS

REF. NO. PART NO.

QUANTITY  
GROUP ASS'Y NOTESGROUP G.1.A. CHANGE MECHANISM TO SUIT L.H. CONTROL  
(CONTINUED)

ROD, pull column to lever, with housing RG.6766 (not supplied separately)	30	RG.6773	1	
ROD, pull, selector mechanism	31	RG.5772	1	
SCREW, cheesehead, 2 BA, cover	X.46	K.1949/Z	2	
SCREW, set, 2 BA operating rod, fork	X.54	KC.175/Z	1	
SCREW, set .312" dia. support stay	X.56	KC.295/Z	1	
SCREW, socket head, upper housing	32	RF.6528	2	
SHAFT, gear change lever	33	RG.5744	1	
SHAFT, reverse light operating	34	RG.5729	1	
SHAFT, selector cross	35	RG.5740	1	
SPINDLE, gear change lever		RF.6971	1	
SPRING, ball pin pad	36	GB.3408	2	
SPRING, pull off	37	RF.8079	1	
STAY, support column to lever	38	RG.6953	2	
STRAP, bellcrank lever bracket	39	RF.6530	1	
STRAP, lower bearing housing with 2 off stud KB.362/Z	40	RF.6532A	1	
STRAP, upper bearing housing	41	RF.6523	1	
TUBE, cross, gear change assembly with housing RG.6766	42	RG.6765	1	
TUBE, gear change assembly including	43	RF.6997	1	
Base support		RF.6994	1	
Bush, oilite		RF.6289	2	
Piece, extension		RF.6526	1	
Plate, backing spring, gear change		RF.6973	1	
Rivet, spring, gear change		KB.1808	1	
Spring, leaf, gear change		RF.6972	1	
Tube, gear change		RF.6511	1	
TUBE, gear change, as above except for length of tube		RF.9498	1	*
TUBE, inner	44	RF.6512	1	
TUBE, inner		RF.9499	1	
WASHER	45	FW.337	2	
WASHER, Grover, .250" dia. cotter	X.81	K.4508/Z	2	
WASHER, Grover, 2 BA cotter	X.81	K.4506/Z	2	
WASHER, housing	46	RF.6527	1	
WASHER, plain, .312" dia. bellcrank lever bracket	X.85	K.4410/Z	1	
WASHER, plain, .250" dia., cotter	X.85	K.4407/Z	2	
WASHER, plain, .200" dia., cotter	X.85	K.4404/Z	2	
WASHER, spring, 2 BA stud bellcrank lever bracket	X.87	K.9006/Z	2	
WASHER, spring .250" dia.	X.87	K.9008/Z	7	
WASHER, spring 2 BA screw fork	X.87	K.9006/Z	2	

G5/12/54.

SCHEDULE OF SPARE PARTS

REF. NO. PART NO.

QUANTITY  
GROUP ASS'LY

NOTES

GROUP G.1.A. CHANGE MECHANISM TO SUIT L.H. CONTROL (Cont'd)

WASHER, spring, .312" dia. support & stay	X.87	K.9009/Z	1	
WASHER, 7 BA inner tube	X.85	K.4450/Z	2	
WASHER, selector shaft	47	RG.7014	1	

NOTE: \* For use when 2" longer steering column is required.

GROUP G.1.B. CHANGE SPEED MECHANISM (AUTOMATIC TRANSMISSION)

Comprising:-

ADAPTOR, spring, selector lever	RF.9124		1	
BEARING, flexible, strap pin	RG.5085		2	
BODY, ball joint, throttle valve control rods	E.70594		4	
BOLT, clamping ball joint body	RE.3520		4	
BOLT, clamping gearbox throttle valve lever	UA.103/Z		1	
BOSS, captive, reverse stop plate	RF.9169		1	V
BOSS, captive, reverse stop plate	RF.10041		1	W
BUSH, clamping, control rod fork	RG.5763		1	
BRACKET, support, lower, assembly	RF.9112		1	
BUTTON, gear range selector lever	RF.9414		1	
BUSH, bearing, operating tube	RF.9175		1	
COVER, bottom, control quadrant	RF.9115		1	
COVER, dust, manual control ball joints	RG.6768		5	
DOWEL, steering tube to lower support bracket	RF.6519		1	
FORK, gear selector rod	RG.5745		1	
HOUSING, manual control ball joints	RG.6767		5	
KNOB, gear range, selector lever	RF.9147		1	
LEVER, bellcrank, gear range selector control assembly, consisting of:-	RG.7240		1	
+ Ball	RG.7242		3	
+ Bush	GB.3615		2	
+ Lever	RG.7241		1	
LEVER, bellcrank, throttle control, assembly consisting of:-	RE.18397		1	
+ Ball	RE.3527		2	
+ Bush	GB.3615		2	
+ Lever	RE.18396		1	
LEVER, gear range selector, assembly consisting of:-	RF.9100		1	
+ Arm	RF.9255		1	
+ Fork	RF.9254		1	
Plate, stop, bottom	RF.9126		1	
Plate, stop, top	RF.9125		1	
Rivet	KB.1874		2	

## SCHEDULE OF SPARE PARTS

REF. NO. PART NO.

QUANTITY  
GROUP ASSEMBLY

NOTES

## GROUP G.1.B. CHANGE SPEED MECHANISM (Cont'd)

LEVER, gearbox, manual control, assembly consisting of:-	UG. 121	1	
+ Ball	RG. 7242		2
+ Lever	UG. 106		1
LEVER, ratchet, gear range selector lever assy. consisting of:-	RF. 9157	1	
+ Lever	RF. 9120		1
Pin, plain	RF. 9154		1
Pin, stepped	RF. 9155		1
LEVER, throttle control, gearbox, assembly consisting of:-	UG. 122	1	
+ Ball	RE. 3527		1
+ Lever	UG. 107		1
NUT, clamping throttle control ball joints	RE. 3667	4	
NUT, full, 5 BA gear range selector knob	K. 4003/Z	1	
NUT, half, 2 BA, locking throttle control rods	K. 4307/Z	4	
NUT, half, 2 BA, selector fork setscrew	K. 4307/Z	1	
NUT, half, .250" dia. bellcrank lever shaft	K. 4310/Z	2	
NUT, half, .250" dia., lower strap studs	K. 4310/Z	2	
NUT, half, .3125" dia., housing	K. 4313/Z	5	
NUT, half, .3125" dia., locking operating rod	K. 4313/Z	2	
NUT, half, .3125" dia., support stay	K. 4313/Z	1	
NUT, half, .4375" dia., adjusting screw	K. 4319/Z	1	
PIECE, distance, ratchet lever	RF. 9156	1	
PIN, strap, lower	RG. 5743	1	
PIN, ball joint housing	RG. 6770	5	
PIN, pivot, gear range selector lever	RF. 9152	1	
PIN, split, ratchet lever	K. 4646/Z	2	
PIN, split, pivot pin	K. 4648/Z	1	
PLATE, guide control quadrant gear change	RF. 10040	1	W
PLUG, ball joint housing	RG. 6769	5	
QUADRANT, control, assembly consisting of:-	RF. 9790	1	
Dowel, stop plates	RF. 9176		4
Plate, stop, forward	RF. 9121		1
Plate, stop, reverse	RF. 9122		1
+ Quadrant	RF. 9113		1
Stud, 3 BA, forward stop plate	KC. 120/Z		1
Stud, 3 BA, reverse, stop plate	RF. 9172		1
RING, rubber, quadrant cover	RF. 9964	6	
ROD, control, throttle, bellcrank to gearbox	RG. 7313	1	
ROD, control, throttle cross shaft to bellcrank	RG. 7452	1	
ROD, control, manual, bellcrank to gearbox	RG. 7238	2	
ROD, control, manual, column to bellcrank	RG. 7453	1	
ROD, operating, neutral and reverse stop	RF. 9260	1	
SCREW, adjusting, ball joint	E. 70595	4	
SCREW, adjusting, gear control tube	RF. 6129	1	

G7/12/54.

## SCHEDULE OF SPARE PARTS

REF. NO. PART NO.

QUANTITY  
GROUP ASS'LY

NOTES

## GROUP G.1.B. CHANGE SPEED MECHANISM (Cont'd)

SCREW, quadrant strap	RF.6528	2	
SETSCREW, 3 BA, quadrant bottom cover	RF.9963	3	
SERSCREW, 2 BA, selector fork	KC.175/Z	1	
SETSCREW, .3125" dia., support stay	KC.295/Z	1	
SHAFT, bellcrank levers	RG.5744	1	
SPRING, selector lever adaptor	RF.9116	1	
SPRING, selector lever button	RF.9117	1	
STAY, support	RG.6953	2	
STRAP, control quadrant	RF.6523	1	
STRAP, lower support bracket, with 2 off stud KB.362/Z	RF.6532A	1	
STRIP, operating micro switches (where fitted)	RF.9674	1	
TUBE, gear control, assembly, consisting of:-	RF.9111	1	
Bush, rubber	RF.6501	1	
+ Lever	RF.9110	1	
+ Pin	RF.9145	1	
Plug, felt	RF.9441	1	
+ Tube, lower	RF.9171	1	
+ Tube, top	RF.9170	1	
TUBE, gear control assembly, as above, except	RF.10260	1	=
Tube, lower	RF.10241	1	
WASHER, gear control lever	UG.141	1	
WASHER, lock, control quadrant	KB.7103	2	
WASHER, bellcrank lever shaft	FW.337	2	
WASHER, plain, 3 BA quadrant cover	RF.9970	3	
WASHER, spring, 2 BA selector fork	K.9006/Z	1	
WASHER, spring, .250" dia., bellcrank lever shaft	K.9008/Z	2	
WASHER, spring .250" dia., lower support strap pin	K.9008/Z	2	
WASHER, spring .250" dia., lower support strap studs	K.9008/Z	2	
WASHER, spring, .3125" dia., support stay	K.9009/Z	1	

NOTE: = For use when 2" longer steering column is required.

## SCHEDULE OF SPARE PARTS

REF. NO. PART NO. QUANTITY  
GROUP ASS'Y NOTESGROUP G. 1. C. CHANGE SPEED MECHANISM - AUTOMATIC  
(RC ONLY)

Comprising:-

ADAPTOR, spring, selector lever	RF. 9124	1	
BOLT, lever, T.V. controls	K. 131/Z	1	
BOLT, .312" dia. clamping, operating lever gear change	K. 309/Z	1	
BOSS, captive, reverse stop plate	RF. 9169	1	V
BOSS, captive, reverse stop plate	RF. 1004.1	1	W
BRACKET, mounting, isolating links, dashboard	RG. 8313	1	
BUSH, bearing, operating tube	RF. 9457	2	
BUSH, clamping, control linkage	RG. 5763	1	
BUSH, rubber, links, isolating	RG. 5085	4	
BUTTON, gear change selector lever	RF. 9414	1	
COVER, bottom, control quadrant	RF. 9115	1	
COVER, dust, ball joints	RG. 6768	5	
HOUSING, ball joints	RG. 6767	5	
JAW, operating, rod, column to lever	RG. 8194	1	
KEY, Woodruff, operating tube (.125)	KC. 505	1	A
KEY, Woodruff, operating tube (.1255)	KC. 506	1	A
KEY, Woodruff, operating tube (.126)	KC. 507	1	A
KEY, Woodruff, operating tube (.1265)	KC. 508	1	A
KNOB, gear change, selector lever	RF. 9147	1	
LEVER, gear range, selector assembly consisting of:-	RF. 9100	1	
Arm	RF. 9255	1	
Fork	RF. 9254	1	
Plate, stop, bottom	RF. 9126	1	
Plate, stop, top	RF. 9125	1	
Rivet	KB. 1874	2	
LEVER, gearbox, manual control assembly consisting of:-	RG. 8169	1	
Ball	RG. 724.2	1	
Lever	RG. 8168	1	
LEVER, ratchet, gear change selector lever assembly, consisting of:-	RF. 9157	1	
Lever	RF. 9120	1	
Pin, plain, lever rivet	RF. 9154	1	
Pin, operating rod	RF. 9155	1	
LEVER, throttle control, gearbox	RG. 8455	1	
LEVER, operating gear change assembly consisting of:-	RF. 9440	1	
Ball	UG. 421	1	
Lever	RF. 9439	1	
Pin, operating micro switches	RF. 9500	1	
Plate, spring	UR. 422	1	

G9/12/54.

## SCHEDULE OF SPARE PARTS

REF. NO. PART NO.

QUANTITY  
GROUP ASS'Y

NOTES

## GROUP G.1.C. CHANGE SPEED MECHANISM (Cont'd)

LINKS, isolating assembly, to socket, consisting of:-	RG.8311	1	
Link, upper	UG.683	1	
Link, lower	UG.685	1	
Rivet	KB.1970	2	
Socket	RG.8177	1	
NUT, .312" dia. adjusting screw	K.4313/Z	1	
NUT, .312" dia. housing, ball joint (5) operating rods (4)	K.4313/Z	9	
NUT, .312" dia. clamping bolt, operating gear change lever	K.4313/Z	1	
NUT, .250" dia. bracket, isolating link	K.4008/Z	2	
NUT, .250" dia. lever, operating, gearbox	K.4310/Z	1	
NUT, 2 BA, pivot, links isolating	K.4307/Z	1	
NUT, 2 BA, lever, T.V. Control	K.4307/Z	1	
NUT, 2 BA, jaw, operating rod	K.4307/Z	1	
NUT, 2 BA, ball joint socket	K.4307/Z	1	
NUT, 5 BA, button, selector lever	K.4003/Z	1	
PIECE, distance, links isolating	K.9739/Z	1	
PIECE, distance, pin, operating rod	RF.9156	1	
PIN, anchor, adaptor spring	RF.9145	1	
PIN, housing, ball joint	RG.6770	5	
PIN, pivot, gear range, selector lever	RF.9152	1	
PIN, split, ratchet lever	K.4646	2	
PIN, split, pivot pin	K.4648	1	
PIVOT, operating tube, upper	RF.9508	1	
PLATE, support assembly, operating tube with 1 off socket RF.9459	RF.9460	1	
PLATE, guide, control quadrant, gear change	RF.10040	1	W
PLUG, housing, ball joint	RG.6769	5	
QUADRANT, control assembly, consisting of:-	RF.9790	1	
Dowel, stop plate	RF.9176	4	
Plate, stop, forward	RF.9121	1	
Plate, stop, reverse	RF.9122	1	
Quadrant	RF.9113	1	
Stud, 3 BA. plate, stop, forward	KC.120/Z	1	
Stud, 3 BA. plate, stop, reverse	RF.9172	1	
RING, rubber, quadrant cover	RF.9964	6	
ROD, operating, stop mechanism	RF.9260	1	
ROD, operating, steering column assembly. with 1 off spring eye UG.714	UG.712	1	
ROD, control, lever, operating gearbox	RG.8193	1	
SCREW, adjusting, gear control tube	RF.9455	1	
SCREW, 2 BA, jaw, operating rod, column to lever	KC.175/Z	1	
SCREW, 2 BA, pivot, links, isolating	KC.805/Z	1	

SCHEDULE OF SPARE PARTS

REF. NO. PART NO. QUANTITY NOTES  
GROUP ASS'LY

GROUP G.1.C. CHANGE SPEED MECHANISM (Cont'd)

SCREW, 3 BA quadrant, bottom cover	RF.9963	3	
SCREW, set, .250" dia. lever, operating, gearbox	KC.207/Z	1	
SCREW, socket head, quadrant stop	RF.6528	2	
SOCKET, ball joint, isolating mechanism	RG.8312	1	
SPRING, selector lever adaptor	RF.9116	1	
SPRING, selector lever, button	RF.9117	1	
SPRING, pre-load, upper ball joint	UG.713	1	
STRAP, control quadrant	RF.6523	1	
STUD, .250" dia. bracket, isolating link	K.399/Z	2	
TUBE, distance, isolating links pivot	UG.684	1	
TUBE, gear change operating	RF.9456	1	
TUBE, gear change operating	RF.9981	1	*
TUBE, gear change operating	RF.10310	1	=
TUBE, cross operating assembly consisting of:-	RG.8314	1	=
Lever, operating assembly consisting of:-	RG.8166	1	
Bush, rubber	RF.6501	1	
Lever	RG.8167	1	
Fin, ball	RG.8164	2	
Pivot, operating tube to cross tube	RG.8163	1	
Tube, cross RH to LH gear change	RG.8161	1	
Tube, operating, gearchange	RG.8162	1	
WASHER, gear control	UG.141	1	
WASHER, lock, 3 BA, control quadrant	KB.7103	2	
WASHER, plain 3 BA, quadrant cover	RF.9970	3	
WASHER, plain, .312" dia. bracket, isolating link	K.4410/Z	1	
WASHER, spring, .312" dia. bolt, operating lever	K.9009/Z	1	
WASHER, spring, .250" dia. lever operating, gearbox	K.9008/Z	1	
WASHER, spring, 2 BA, lever, T.V. control	K.9006/Z	1	
WASHER, spring, 2 BA, jaw operating rod lever	K.9006/Z	1	
WASHER, spring, 2 BA, pivot, isolating link	K.9006/Z	1	
WASHER, heavy, 2 BA, bracket, isolating link	KB.3904/Z	1	

NOTE:- \* For use when 2" longer steering column is fitted.

= For use when 1½" shorter steering column is fitted.

## SCHEDULE OF SPARE PARTS

REF. NO. PART NO.

QUANTITY  
GROUP ASS'LY

NOTES

## GROUP G.1.D. CHANGE SPEED MECHANISM (LC ONLY)

Comprising:-

ADAPTOR, spring, selector lever	RF.9124	1	
BEAM, balance assembly, gear change consisting of:-	RG.8329	1	
Beam	RG.8330	1	
Pivot, long	RG.8336	1	
Pivot, short	RG.8337	1	
BOLT, .250" dia. 2.400" long, bracket to dashboard, isolating link	K.222/Z	1	
BOLT, .250" dia. 2.00" long, bracket to dashboard	K.218/Z	1	
BOLT, .312" dia. clamping, operating lever	K.309/Z	1	
BOLT, 2 BA, pivot, operating lever, micro switch	K.102/Z	1	
BOLT, 5 BA, operating washer, micro switch	K.3708/Z	1	
BOLT, clamping, gearbox throttle lever	K.131/Z	1	
BOSS, captive, reverse stop plate	RF.9169	1	V
BOSS, captive, reverse stop plate	RF.10041	1	W
BRACKET, mounting, isolating links (dashboard)	RG.8321	1	
BUSH, bearing, operating tube	RF.9457	2	
BUSH, rubber, gear change linkage	RG.5085	6	
BUTTON, gear selector lever	RF.9414	1	
COVER, bottom, control quadrant	RF.9115	1	
COVER, dust, ball joint	RG.6768	3	
HOUSING, ball joint	RG.6767	3	
KEY, Woodruff, operating tube (.125)	KC.505	1	A
KEY, Woodruff, operating tube (.1255)	KC.506	1	A
KEY, Woodruff, operating tube (.126)	KC.507	1	A
KEY, Woodruff, operating tube (.1265)	PC.508	1	A
KNOB, gear range selector lever	RE.9147	1	
LEVER, bellcrank assembly, consisting of:-	RG.8342	1	
Ball	RG.8334	1	
Boss	RG.8338	1	
Bush, oilite	RF.9423	2	
Bush, rubber	RF.6501	1	
Lever	RG.8341	1	
LEVER, gear range selector assembly consisting of:-	RF.9100	1	
Arm	RF.9255	1	
Fork	RF.9254	1	
Plate, stop, bottom	RF.9126	1	
Plate, stop, top	RF.9125	1	
Rivet	KB.1974	2	

## SCHEDULE OF SPARE PARTS

REF. NO. PART NO.

QUANTITY  
GROUP ASS'LY

NOTES

## GROUP G.1.D. CHANGE SPEED MECHANISM (Cont'd)

LEVER, gearbox, manual control assembly  
consisting of:-

Ball pin

Lever

LEVER, gear change operating assembly  
consisting of:-

Ball pin

Lever

Plate, spring

LEVER, micro switch operating

LEVER, ratchet, gear range selector  
assembly consisting of:-

Lever

Pin, operating rod

Pin, lever rivet

LEVER, gearbox, throttle valve control

LINK, isolating

NUT, screw, adjusting gear change tube

NUT, 5 BA, bottom, gear selector lever

NUT, 5 BA, operating washer, micro switch

NUT, .250" dia. balance beam, pivot on dashboard  
bracket

NUT, .250" dia. lever, gearbox, manual control

NUT, .250" dia. bolts, bracket, dashboard

NUT, 2 BA, lever, throttle valve control

NUT, 2 BA, pivot, micro switch, operating  
lever

NUT, 2 BA, pivot, balance beam

NUT, .250" dia. bracket on dashboard

NUT, .250" dia. pivot, balance beam

NUT, .312" dia. adjusting screw

NUT, .312" dia. bolt, clamping, operating  
lever

NUT, .312" dia. ball joint housing

NUT, .312" dia. operating rod, gear change

NUT, .312" dia. balance beam, gear change

NUT, .312" dia. isolating link

NUT, .312" dia. control rod to bellcrank

NUT, .250" dia. strap lower

PLATE, spring, anchor, pre-load spring to  
control rod

PIECE, distance, pin, operating rod

PIECE, distance, bracket to dashboard

PIN, anchor, adaptor spring

RG.8169

1

RG.7242

1

RG.8168

1

RF.9845

1

UR.421

1

RF.9439

1

UR.422

1

RF.9840

1

RF.9157

1

RF.9120

1

RF.9155

1

RF.9154

1

RG.8455

1

RG.8340

1

K.4319/Z

1

K.4003/Z

1

K.4301/Z

1

K.4310/Z

1

K.4310/Z

1

K.4008/Z

2

K.4307/Z

1

K.4307/Z

1

K.4307/Z

1

K.4008/Z

2

K.4008/Z

1

K.4313/Z

1

K.4313/Z

1

K.4313/Z

3

K.4313/Z

2

K.4313/Z

1

K.4313/Z

1

K.4313/Z

1

K.4310/Z

2

RG.8339

1

RF.9156

1

RG.8431

1

RF.9145

1

## SCHEDULE OF SPARE PARTS

REF. NO. PART NO.

QUANTITY  
GROUP ASS'LY

NOTES

## GROUP G.1.D. CHANGE SPEED MECHANISM (Cont'd).

PIN, ball joint housing	RG.6770	3	
PIN, pivot, fork, selector lever	RF.9152	1	
PIN, pivot, micro switch operating lever	RF.9841	1	
PIN, split, ratchet lever	K.4646/Z	2	
PIN, split, pivot pin	K.4648/Z	1	
PIVOT, operating tube, top	RF.9508	1	
PIVOT, operating lever pin, micro switch	RF.9842	1	
PIVOT, balance beam, gear change	RG.8331	1	
PLATE, guide, control quadrant gear change	RF.10040	1	W
PLUG, ball joint housing	RG.6769	3	
QUADRANT, control assembly consisting of:-	RF.9790	1	
Dowel, stop plates	RF.9176	4	
Plate, stop forward	RF.9121	1	
Plate, stop reverse	RF.9122	1	
Quadrant	RF.9113	1	
Stud, 3 BA, forward stop plate	K.120/Z	1	
Stud, 3 BA, reverse stop plate	RF.9172	1	
RING, rubber, quadrant cover	RF.9964	6	
ROD, operating, neutral & reverse stop	RF.9260	1	
ROD, operating, gear change	RG.8333	1	
ROD, control, gearbox to bellcrank assembly consisting of:-	RG.8326	1	
Piece, distance	RG.8327	1	
Rod	RG.8343	1	
SCREW, adjusting, gear change & tube	RF.6129	1	
SCREW, adjusting, operating tube	RF.9455	1	
SCREW, set 2 BA, control rod to bellcrank	KC.160/Z	1	
SCREW, set .250" dia. operating lever	KC.207/Z	1	
SCREW, 3 BA, bottom cover, control quadrant	RF.9963	3	
SCREW, socket head, strap, control quadrant	RF.6528	2	
SPRING, pre-load, ball joint	RE.17032	1	
SPRING, selector lever, adaptor	RF.9116	1	
SPRING, selector lever button	RF.9117	1	
STRAP, control quadrant	RF.6523	1	
STAY, support, balance to bracket	RG.8328	1	
STUD, .250" dia. strap, lower	KB.362/Z	2	
TUBE, operating, gear change	RF.9807	1	
TUBE, operating, gear change	RF.9958	1	
WASHER, operating, micro switches	RF.9843	1	
WASHER, gear control lever	UG.141	1	
WASHER, lock, 3 BA, stop plate	KB.7103	2	
WASHER, plain 3 BA, quadrant cover	RF.9970	3	
WASHER, heavy, 2 BA, balance beam pivot	KB.3904/Z	1	
WASHER, plain, 2 BA, control rod to bellcrank	RG.8537	1	
WASHER, spring, 2 BA, lever T.V. control	K.9006/Z	1	
WASHER, spring, 2 BA, micro switch pivot	K.9006/Z	1	
WASHER, spring, 2 BA, balance beam pivot	K.9006/Z	1	

## SCHEDULE OF SPARE PARTS

REF. NO. PART NO. QUANTITY  
GROUP ASSEMBLY NOTES

## GROUP G.1.D. CHANGE SPEED MECHANISM (Cont'd)

WASHER, spring, 2 BA, control rod to bellcrank		K.9006/Z	1
WASHER, spring, .250" dia. bracket, dashboard		K.9008/Z	2
WASHER, spring, .250" dia. balance beam pivot		K.9008/Z	2
WASHER, spring, .250" dia. lever operating		K.9008/Z	1
WASHER, strap lower		K.9008/Z	2
WASHER, spring, .312" dia. balance beam		K.9009/Z	1
WASHER, spring, .312" dia. isolating link		K.9009/Z	1
WASHER, spring, .312" dia. bolt, clamping lever operating		K.9009/Z	1
WASHER, plain, 5 BA, operating washer, micro switch		K.4401/Z	1
WASHER, spring, 5 BA, operating washer, micro switch		K.9003/Z	1
WASHER, gear change linkage		RG.8335	1
WASHER, pivot, on dashboard, balance beam		RG.8415	1

NOTE: \* For use when 2" longer steering column is fitted.

GROUP G.2. DAMPER CONTROL PUMP AND SPEEDOMETER DRIVE  
(SYNCHROMESH ONLY)

Comprising:-

BALL, stud, .406" dia. valve	1		1
BOLT, 5 BA, operating lever	X.7	K.3706/Z	1
BUSH, driving	2	GB.4812	1
COLLAR, valve lever pivot	X.16	KB.1178/Z	1
COVER	3	GB.4814DC	1
COVER, valve spring	4	GB.5345	1
GEAR, driving 8 teeth	5	GB.3757	1
GEAR, driven, oil pump, 15 teeth	6	GB.3572	1
GEARSHAFT, driving oil pump, 15 teeth	7	RG.464	1
HOUSING, pump assembly, consisting of:-	8	RG.463A	1
Bolt, 2 BA, disc retaining		KB.7866/Z	3
+ Disc, bearing		GB.4811	1
+ Housing		RG.463	1
Nut, full 2 BA, disc and pivot		K.4006/Z	1
Pivot, valve lever		GB.3562	1
Washer, lock, disc, retaining nut		KB.7104	3

G15/12/54.

## SCHEDULE OF SPARE PARTS

REF. NO. PART NO.

QUANTITY  
GROUP ASSEMBLY

NOTES

## GROUP G.2. DAMPER CONTROL PUMP AND SPEEDOMETER DRIVE (Cont'd)

JOINT, cover and housing	9	GB.4950	2	
LEVER, operating, external	10	GB.3565	1	
LEVER, valve, internal	11	GB.3567DC	1	
NUT, castellated, .250" dia. driving gear	X.20	K.4208/Z	1	
NUT, full, 5 BA, operating lever bolt	X.21	K.4003/Z	1	
NUT, lock, 2 BA, pump casing	X.24	K.4307/Z	3	
PIN, operating	12	GB.5022DC	1	
PIN, split, .052" dia. driving gear nut (1) and valve lever pivot (1)	X.31	K.4602/Z	2	
PLUG, felt, speedometer drive	13	GB.4810	1	
SPRING, valve	14	GB.3566	1	
WASHER, plain .250" dia. driving gear	X.85	K.4407/Z	1	
WASHER, spring 5 BA, operating lever bolt	X.87	K.9003/Z	1	

## GROUP G.3. FIRST MOTION SHAFT (SYNCHROMESH)

Comprising:-

BEARING, ball	1	RG.5958	1	A
BEARING, ball		RG.6591	1	A
CONE, synchromesh, 4th speed assembly consisting of:-	2	RG.4281	1	
+ Cone		RG.4278	1	
+ Insert		RG.3240	1	
+ Rivet		KB.12568/Z	4	
GEARSHAFT, 18 teeth, 1st motion	3	GB.5338	1	
NUT, ball bearing, retaining	X.23	KB.3541/Z	1	
RETAINER, roller (assembly purposes only)	4	RG.3130	1	
ROLLER, 1st motion shaft bearing (Fischer)	5	GB.5282	14	A
ROLLER, 1st motion shaft bearing (R. & M.)		RG.6584	14	A
ROLLER, 1st motion shaft bearing (Hoffman)		RG.7080	14	A
WASHER, plain, ball bearing	6	GB.5360	1	
WASHER, locking, ball bearing nut	7	GB.5382	1	

## GROUP G.4. GEARBOX (SYNCHROMESH)

Comprising:-

ADAPTOR, oil supply to damper	1	RG.168	1	
BEARING, selector shaft (LC)	2	RG.5737	1	
BOLT, .250" dia. backing plate to housing(LC)	X.10	K.205/Z	1	
BOLT, .312" dia. rear cover foot	X.11	K.306/Z	2	
BRACKET, reverse light switch (LC)	3	RG.5731	1	

## SCHEDULE OF SPARE PARTS

REF. NO. PART NO.

QUANTITY  
GROUP ASSEMBLY

NOTES

## GROUP G.4. GEARBOX (Cont'd)

CIRCLIP, Seegar .812" bore, locating piece	4	KB.14017	1	
COVER, bottom drain, assembly, with 1 off adaptor RG.3321	5	RG.3119A	1	
COVER, large L.H. side, assembly with patent number plate (RC)	6	RG.4403	1	
COVER, large, L.H. side assembly, with patent number plate (LC)	7	RG.5738	1	
COVER, L.H. gear change bore (RC)	8	RG.429DC	1	
COVER, main front	9	RG.5309	1	
COVER, main, rear assembly, with 2 off stud KB.402/Z	10	RG.5310A	1	
COVER, selector bars, rear	11	RG.7315	1	
COVER, selector shaft actuation (LC)	12	RG.7085	1	
COVER, top inspection (RC)	13	GB.4126	1	
COVER, top inspection (LC)	14	RG.5618	1	
CUP, felt, washer, oil seal (LC)	15	RG.5728	1	
DIPSTICK assembly	16	GB.5130A	1	
FORK and JAW, reverse operating		RG.167		
GATE, gear change (LC)	17	RG.5736	1	
GEARBOX, assembly, consisting of(RC) :-	18	RG.3117A	1	
+ Casing		RG.3117		1
Plug, damper control housing, and selector lock drilling		RG.3322		2
Stud, 2 BA, damper pump control shaft, bracket		KB.256/Z		2
Stud, 2 BA, L.H. gear change bore		KB.253/Z		4
Stud, .250" dia. pressed steel covers		KB.399/Z		28
Stud, .250" dia., damper control housing		KB.351/Z		3
Stud, .250" dia. front cover		KB.353/Z		6
Stud, .250" dia. rear main cover		KB.366/Z		2
Stud, .250" dia. rear main cover		KB.353/Z		3
Stud, .250" dia. rear support bracket		KB.355/Z		7
Stud, .250" dia. selector eccentric pin covers		KB.350/Z		6
Stud, .250" dia. selector rod cover		KB.360/Z		4
GEARBOX (LC) assembly as above, except:-		RG.3117B	1	
Plug, damper control bracket		RG.7012		2
Stud, .250" dia., pressed steel cover	X.67	KB.399/Z		18
Stud, 2 BA, backing plate		KB.250/Z		1
Stud, 2 BA, backing plate		KB.273/Z		3
Stud, .250" dia. shaft bearing and gate		KB.352/Z		7
Stud, .250" dia. housing		KB.367/Z		1
Stud, .250" dia. housing		KB.371/Z		1

## SCHEDULE OF SPARE PARTS

REF. NO. PART NO.

QUANTITY  
GROUP ASS'LY

NOTES

## GROUP G.4. GEARBOX (SYNCHROMESH) (Cont'd)

The following studs are not used on (LC):

KB.256/Z, KB.253/Z.

JOINT, laminated cork, bottom drain cover	19	RG.3120	1	
JOINT, laminated cork, L.H. side cover (RC)	20	RG.170	1	
JOINT, laminated cork, top inspection cover	22	GB.4125	1	
JOINT, vellumoid, L.H. side cover (LC)	24	RG.5660	1	
JOINT, vellumoid, L.H. gear change bore cover	23	RG.427	1	
JOINT, vellumoid, main front cover	25	GB.4123	1	
JOINT, vellumoid, main rear cover	26	GB.4833	1	
JOINT, vellumoid, top cover and gate (LC)	27	RG.5659	2	
JOINT, vellumoid, backing plate to housing (LC)	28	RG.5776	1	
JOINT, vellumoid, selector shaft, R.H. bearing (LC)	29	GB.4124	1	
NUT, half, 2 BA. L.H. gear change bore and damper control shaft brackets		K.4307/Z	6	
NUT, half, 2 BA, backing plate to housing (LC)		K.4307/Z	4	
NUT, half, .250" dia. (RC)		K.4310/Z	59	
NUT, half, .250" dia. (LC)		K.4310/Z	61	
NUT, half, .312" dia. rear cover, foot bolt		K.4313/Z	2	
NUT, half, .312" dia. tie rod seating stud		K.4313/Z	2	
NUT, reach, conduit clips (LC)	30	RG.6162	1	
PACKING, rear cover, foot	31	GB.5266	4	
PACKING, reverse light switch (LC)		RG.7038		B
PACKING, reverse light switch (LC)		RG.7039		B
PIECE, locating, servo bearing	32	RG.3129	1	
PLUG, oil drain	33	RG.3744	1	
RING, sealing, servo bearing locating piece		KB.6201	1	
RING, spring, front ball bearing bore	34	RG.5311	1	
RING, spring, rear ball bearing bore	35	RG.5312	1	
SEAL, selector, cross shaft (LC)	36	RG.5730	1	
SCREW, locking, 2nd and reverse bearing shaft	37	GB.5018	2	
SCREW, reverse light bracket (LC)		KC.153/Z	2	
SUPPORT, rear casing assembly with:-	38	RG.174	1	
+ Plate		GB.4895	2	
TUBE, damper control pump, suction assembly consisting of:-	39	GB.3568A	1	
Adaptor		GB.3568	1	
Filter		GB.5035	1	
Tube		RG.172	1	
WASHER, adjusting reverse light switch (LC)				
.040" thick - RG.6384 .060" thick - RG.6386)				
.050" thick - RG.6385 .070" thick - RG.6387)				B

## SCHEDULE OF SPARE PARTS

REF. NO. PART NO. QUANTITY  
GROUP ASS'LY NOTES

## GROUP G.4. GEARBOX (SYNCHROMESH) (Cont'd)

WASHER, aluminium, damper control pump, suction tube	40	RG. 3248	1	
WASHER, aluminium, damper oil supply adaptor		KB. 1097	1	
WASHER, aluminium, oil drain plug		KB. 1093	1	
WASHER, locking, 2nd and reverse bearing shaft locking screw		KB. 7109	2	
WASHER, plain, pressed steel covers (RC)		K. 4407/Z	28	
WASHER, plain, pressed steel covers (LC)		K. 4407/Z	22	
WASHER, spring, 2 BA, L.H. gear change bore and damper control shaft brackets (RC)		K. 9006/Z	6	
WASHER, spring 2 BA. backing plate to housing reverse light bracket (LC)		K. 9006/Z	6	
WASHER, spring, .250" dia. (RC)		K. 9008/Z	57	
WASHER, spring, .250" dia. (LC)		K. 9008/Z	61	
WASHER, spring, .312" dia. rear cover foot bolt		K. 9009/Z	2	

## GROUP G.5. REVERSE MOTION SHAFT (SYNCHROMESH)

Comprising:-

GEARSHAFT, reverse, 21 and 44 teeth, front and rear respectively, assembly consisting of:-	1	RG. 183A	1	
Bush, white-metalled		GB. 5019		2
+ Gearshaft		RG. 183		1
SHAFT, bearing	2	RG. 184	1	
WASHER, thrust	3	RG. 182	1	

## GROUP G.6. SECOND MOTION SHAFT (SYNCHROMESH)

Comprising:-

BEARING, front, Timken roller	1	RG. 5686	1	
BEARING, rear, Timken roller	2	RG. 5687	1	
GEARSHAFT, 2nd motion (23, 17, 20, 12, and 19 teeth, front to rear gears respectively)	3	RG. 3544	1	
RING, sealing, front end	X.34	KB. 6206	1	
SHAFT, bearing	4	RG. 3124	1	
WASHER, rear end	6	GB. 5270	1	

G19/12/54.

## SCHEDULE OF SPARE PARTS

REF. NO. PART NO.

QUANTITY  
GROUP ASS'LY

NOTES

## GROUP G.6. SECOND MOTION SHAFT (SYNCHROMESH) (Cont'd)

WASHER, adjusting, front end

5

A

.080" thick - RG.3131	.082" thick - RG.4474
.084" thick - RG.3132	.086" thick - RG.4475
.088" thick - RG.3133	.090" thick - RG.4476
.092" thick - RG.3134	.094" thick - RG.4477
.096" thick - RG.3135	.098" thick - RG.4478
.100" thick - RG.3136	.102" thick - RG.4479
.104" thick - RG.3137	.106" thick - RG.4480
.108" thick - RG.3138	.110" thick - RG.4481
.112" thick - RG.3139	.114" thick - RG.4482
.116" thick - RG.3140	.118" thick - RG.4483
.120" thick - RG.3141	.120" thick - RG.4484

## GROUP G.7. SELECTOR MECHANISM (INTERNAL)

Comprising:-

ARM, retaining and detent roller assembly	1	RG.7129	1	
BALL, steel, .312" dia. shaft, interfering	1	RG.6594	2	A
BALL, steel .312" dia. shaft, interfering	2	RG.6131	2	A
BALL, steel, .500" dia. shaft, positioning	3	RG.6627	3	
BOLT, 2 BA. retaining, jaw to fork	X.9	K.108/Z	4	
FORK, operating, 1st and 2nd, 3rd and 4th gears	4	GB.5076DC	2	
JAW, bolted to fork	5	GB.5075	2	
LEVER, 1st and 2nd motion, operating	6	GB.4831	1	
LEVER, 3rd and 4th motion, operating	7	GB.4832	1	
LEVER, reverse operating	8	RG.3151	1	
NUT, cap, adjusting screw detent roller	9	RE.9032	1	
NUT, lock, adjusting screw	X.24	K.4313/Z	1	
NUT, full, 2 BA, jaw to fork retaining	X.21	K.4006/Z	4	
NUT, half, .250" dia. pin to operating levers retaining	X.24	K.4310/Z	2	
PIN, actuating, 1st and 2nd, 3rd and 4th motion levers	10	GB.4144	2	
PIN, eccentric, pivot, 1st, 2nd and reverse gears	11	RG.3126	2	
PIN, eccentric pivot, 3rd and 4th gears	12	RG.3127	1	
PIN, retaining arm, detent roller	13	RG.7217	1	
PLATE, eccentric pivot pins, retaining	14	RG.3002	3	
PLATE, locking jaw locating screw	15	GB.4341	4	
RING, guide shaft retaining	16	RG.3354	1	
RING, sealing, eccentric pivot pins	X.34	KB.6201	3	
RING, sealing, operating shaft guide		KB.6201	1	
SCREW, adjusting, retaining arm, detent roller	17	RG.7314	1	

SCHEDULE OF SPARE PARTS

REF. NO. PART NO. QUANTITY NOTES  
GROUP ASS'LY

GROUP G.7. SELECTOR MECHANISM (INTERNAL) (Cont'd)

SCREW, locating, jaw to selector shaft	18	GB. 3451	4	
SCREW, 2 BA, selector shaft jaw locating	X.54	KC. 152/Z	4	
SHAFT, guide, operating forks	19	RG. 3226	1	
SHAFT, selector, 1st and 2nd gears, with jaw GB.5128	20	RG. 7210A	1	
SHAFT, selector, 3rd and 4th gears, with jaw GB.5128	21	RG. 7211A	1	
SHAFT, reverse motion, with jaws GB.5128 and RG.167	22	RG. 7212A	1	
SPRING, shaft, positioning	23	RG. 7213	3	
SPRING, detent roller, 1st and 2nd speed	24	RG. 7215	1	
WASHER, adjusting reverse shaft	25	RG. 5655		B
WASHER, cap nut, detent roller	X.83	KB. 1077/Z	1	
WASHER, lock, 2 BA, selector shaft, jaw lock plate retaining screw	X.89	KB. 7104	4	
WASHER, pin, retaining arm detent roller	X.83	KB. 1076/Z	1	

GROUP G.8. SERVO MOTOR DRIVE (SYNCHROMESH)

Comprising:-

BEARING, ball, inner	1	RG. 4449	1	A
BEARING, ball, inner		RG. 6588	1	A
BEARING, ball, inner		RG. 7079	1	A
BEARING, ball, outer	2	RG. 4448	1	A
BEARING, ball, outer		RG. 6587	1	A
BEARING, ball, outer		RG. 7078	1	A
BEARING, ball, outer		RG. 8261	1	A
CIRCLIP, Seegar, outer bearing	3	KB. 14188	1	
CIRCLIP, Seegar, worm wheel	4	KB. 14172	1	
HOUSING, oil seal	5	RG. 3109	1	
JOINT, oil seal housing	6	RG. 3000	1	
NUT, castellated, .437" dia. shaft retaining	X.20	KB. 3589	1	
PIN, servo driving	7	RG. 3222	3	
PIN, split, .993" dia, shaft nut	X.31	K. 4608	1	
SCREW, countersunk lead, 2 BA, housing	X.50	K. 2810	4	
SEAL, oil, Angus "Gaco"	8	RG. 7027	1	
SHAFT	9	RG. 3246	1	
WASHER, inner bearing	10	GB. 4043	1	
WASHER, worm wheel	11	RG. 3705	1	
WHEEL, worm	12	RG. 3419	1	

SCHEDULE OF SPARE PARTS

REF. NO. PART NO.

QUANTITY  
GROUP ASS'Y

NOTES

GROUP G.9. THIRD MOTION SHAFT (SYNCHROMESH)

Comprising:-

BALL, steel, .312" dia. 1st speed gears	1	RG.6131	2	A
BALL, steel, .312" dia. 1st speed gears		RG.6594	2	A
BEARING, ball, centre	2	RG.4447	1	A
BEARING, ball, centre		RG.6595	1	A
BEARING, ball, centre		RG.7076	1	A
BEARING, ball, rear	3	RG.5959	1	A
BEARING, ball, rear		RG.6592	1	A
BUSH, large dia. flange, 2nd and 3rd speed gears	4	RG.6984	2	
BUSH, small dia. flange 2nd and 3rd speed gears	5	RG.6983	2	
CONE, synchromesh, 2nd speed assembly	6	RG.3245	1	
CONE, synchromesh, 3rd speed assembly	7	RG.4280	1	
FLANGE, rear coupling	8	RG.3121	1	
GEAR, 21 teeth, 3rd speed driven	9	RG.100	1	T
GEAR, 21 teeth, 3rd speed driven		RG.8459	1	U
GEAR, 28teeth, 1st speed, driven	10	RG.3221	1	
GEAR, 30 teeth, 2nd speed, driven	11	RG.179	1	
GEAR, worm, servo drive	12	RG.3418	1	
KEY, 1st speed gear	13	GB.5391	2	
KEY, locating, 3rd speed gear	14	GB.5359	1	
KEY, 3rd and 4th speed, sliding piece	15	RG.5471	2	
NUT, rear flange	16	G.54923	1	
PIECE, sliding, 3rd to 4th speed	17	RG.5470	1	T
PIECE, sliding, 3rd to 4th speed		RG.8467	1	U
PIN, locating, 3rd speed gears	18	RG.3128	1	
PLUNGER, supporting, sliding piece key	19	RG.7009	4	
SHAFT, 3rd motion	20	RG.5469	1	T
SHAFT, 3rd motion		RG.8472	1	U
SLEEVE, 3rd speed, gear and centre bearing	21	GB.5374	1	T
SLEEVE, 3rd speed, gear and centre bearing		RG.8461	1	U
SPRING, 1st speed gear	22	GB.4875	2	
SPRING, 3rd speed gear, locating pin	23	GB.3408	1	
SPRING, supporting, .187" dia. steel balls	24	GB.4842	2	
WASHER, adjusting, centre bearing	25			
.150" thick - GB.5366		.152" thick - GB.5368		
.154" thick - GB.5370		.156" thick - RG.3496		
.158" thick - RG.3497		.160" thick - RG.3371		
WASHER, adjusting, 2nd speed gear	26			
.173" thick - RG.3498		.175" thick - GB.5361		
.177" thick - GB.5363		.179" thick - GB.5365		

## SCHEDULE OF SPARE PARTS

REF. NO. PART NO.

QUANTITY  
GROUP ASSEMBLY

NOTES

## GROUP G.9. THIRD MOTION SHAFT (Cont'd)

WASHER, adjusting, rear flange

27

.040" thick - RG.6415	.045" thick - RG.6416
.050" thick - RG.6417	.055" thick - RG.6418
.060" thick - RG.6419	.065" thick - RG.6420
.070" thick - RG.6554	.075" thick - RG.6555
.080" thick - RG.6556	.085" thick - RG.6557
.090" thick - RG.6558	.095" thick - RG.6559
.100" thick - RG.6560	.105" thick - RG.6561
.110" thick - RG.6562	.115" thick - RG.6563

WASHER, key, 3rd speed gear

28

RG.7392

1

WASHER, lock, rear flange nut

29

G.54681

1

WASHER, plain, rear flange

30

G.54680

1

WASHER, worm to 2nd speed gears

.325" thick - RG.4350	.345" thick - RG.4351
.265" thick - GB.5371	.385" thick - RG.4352
.405" thick - RG.4353	.425" thick - RG.4354

## SCHEDULE OF SPARE PARTS

REF. NO. PART NO.

QUANTITY  
GROUP ASS'Y NOTES

## GROUP G10. TIE BAR

## Comprising

BLOCK, rubber	1	RG 3428	4
BOLT, .250" dia., tie rod bracket	X.10	K 243/Z	3
BRACKET, assembly, consisting of	2	RG 5939	1
Bracket		RG 5883	1
Cup for rubber block		RG 3431	2
Rivet, .125" dia.		KB 2454	6
NUT, half, .250" dia., bracket to frame bolt	X.24	K 4310/Z	3
NUT, lock, .375" dia.,	X.24	K 4316	7
PIECE, distance, between rubber blocks	3	RG 3429	2
PLATE, packing	4	RG 3434	1
ROD	5	RG 3430	1
SEATING	6	RG 3427	1
WASHER, pressure	7	F 88553	4
WASHER, spring, .250" dia., bracket bolt	X.87	K 9008/Z	3

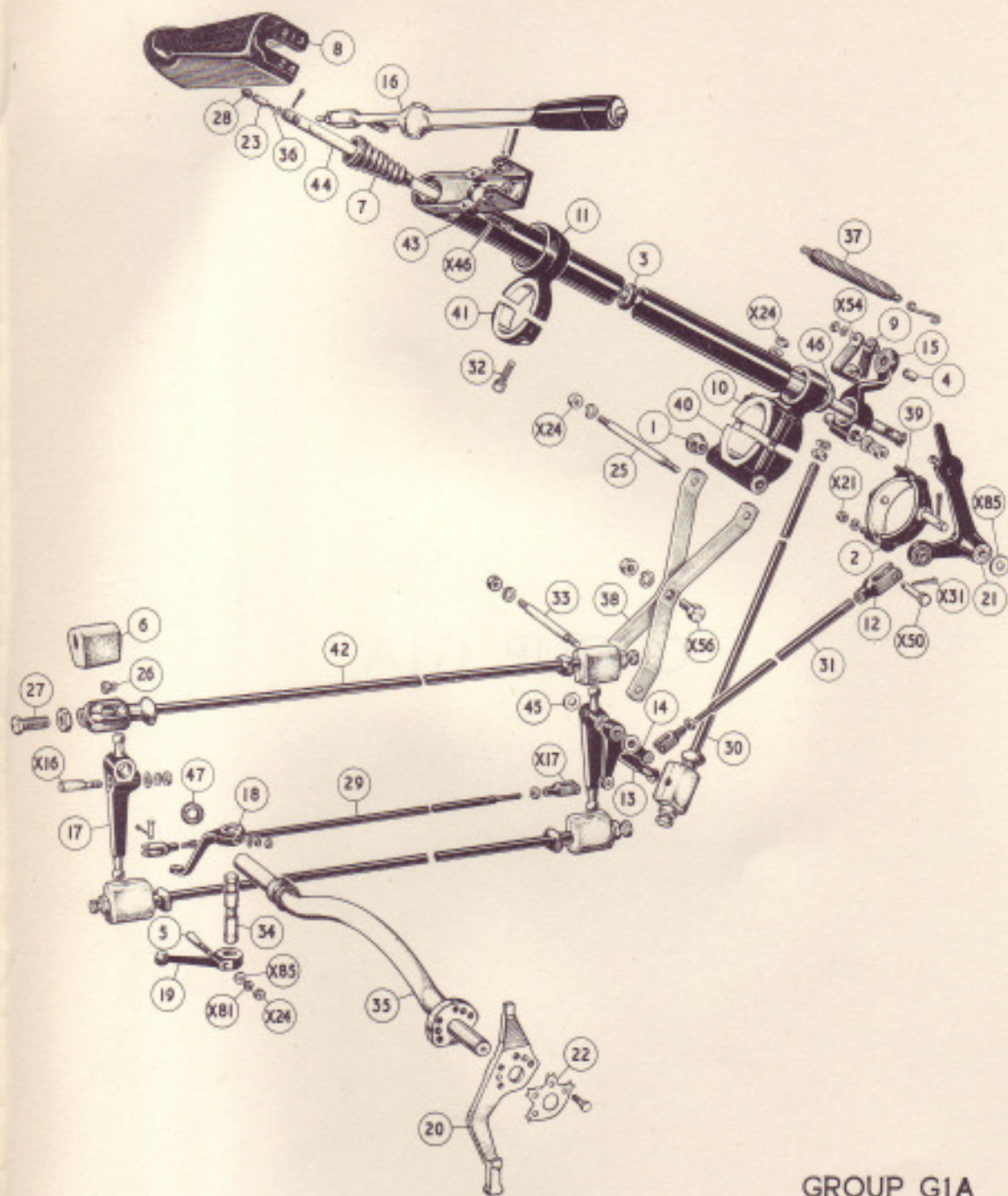

GROUP G1A



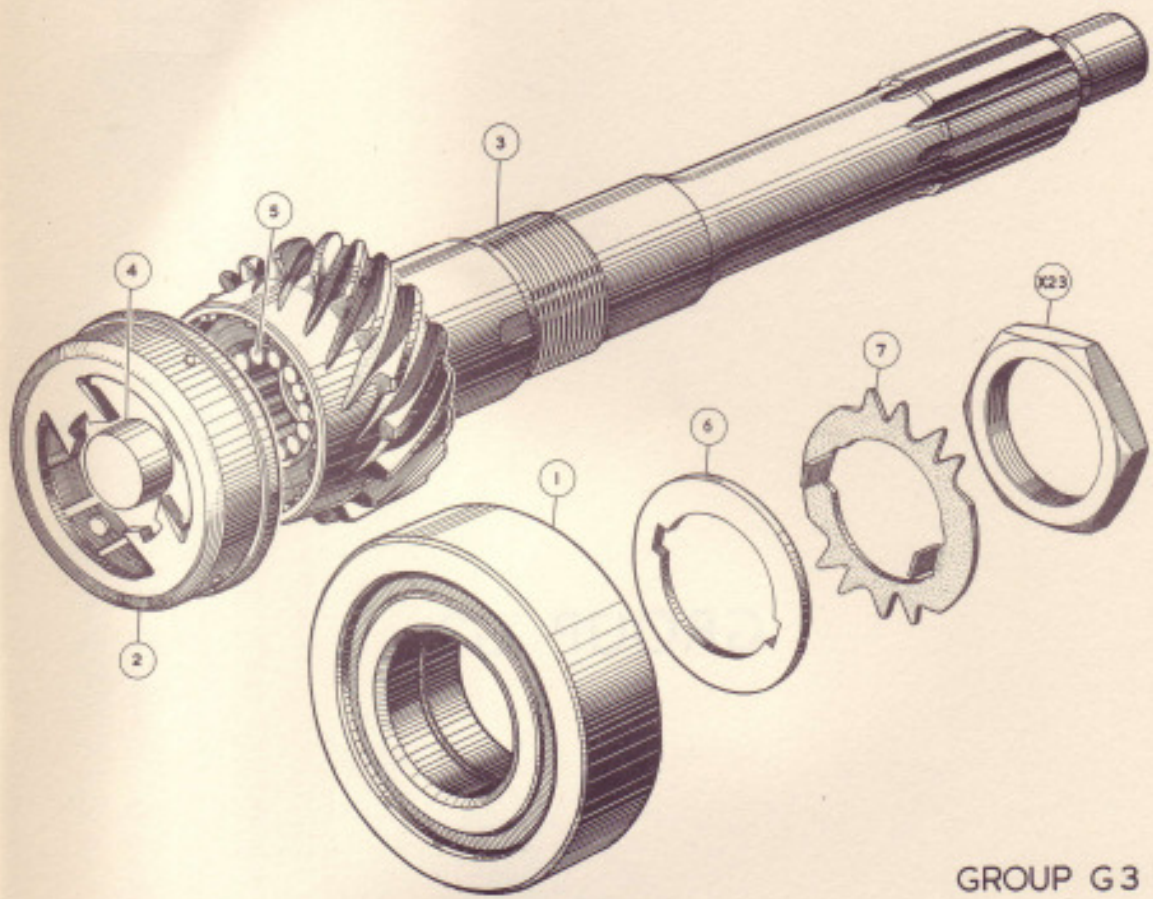

GROUP G 3

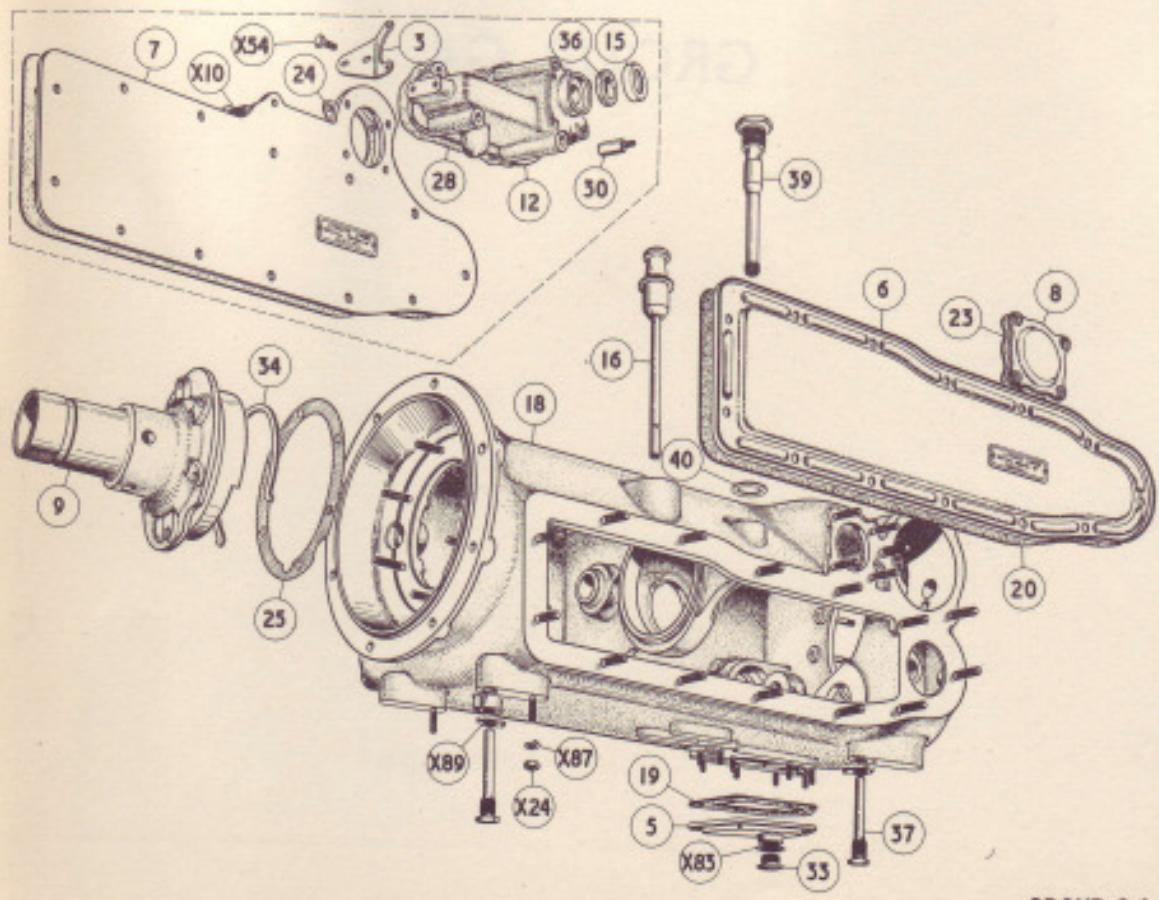
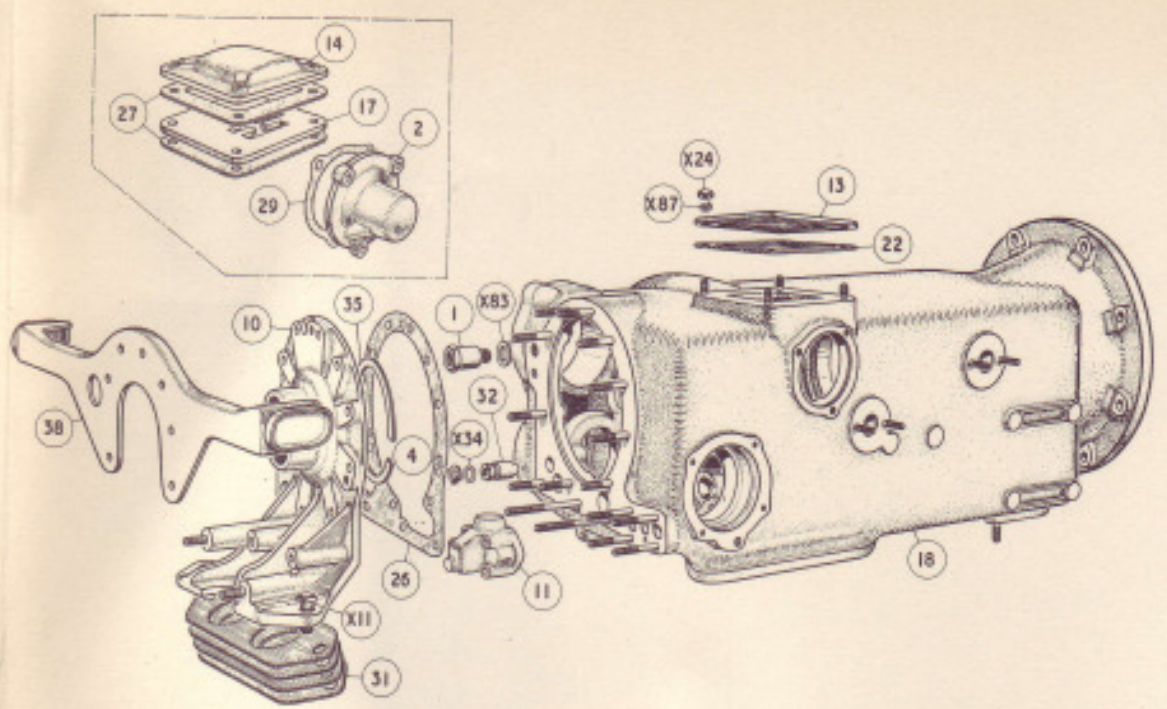

GROUP G4

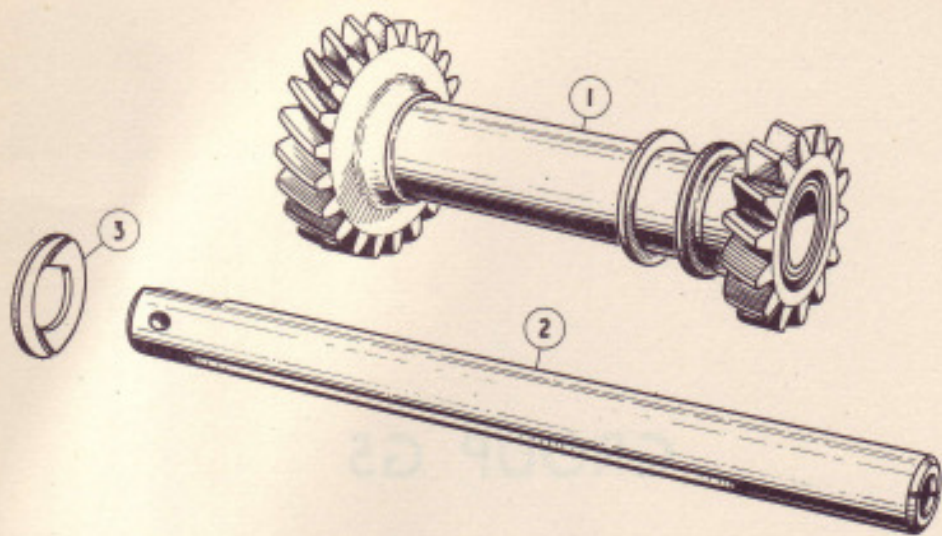

GROUP G5

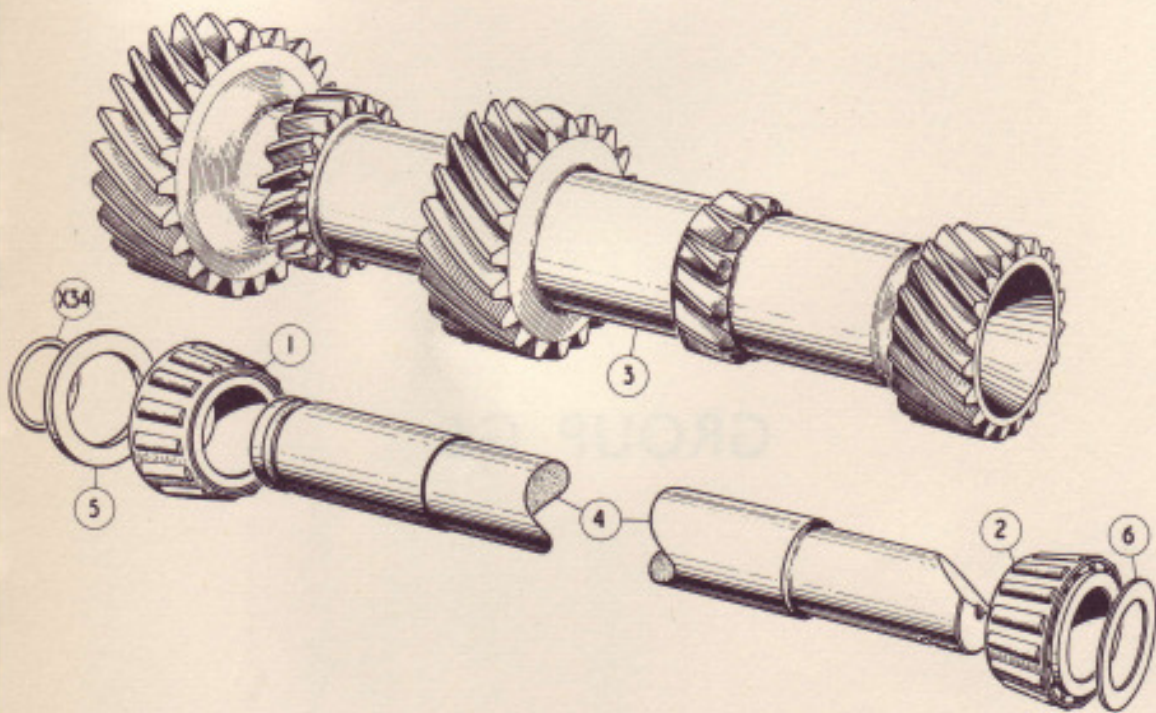

GROUP G6

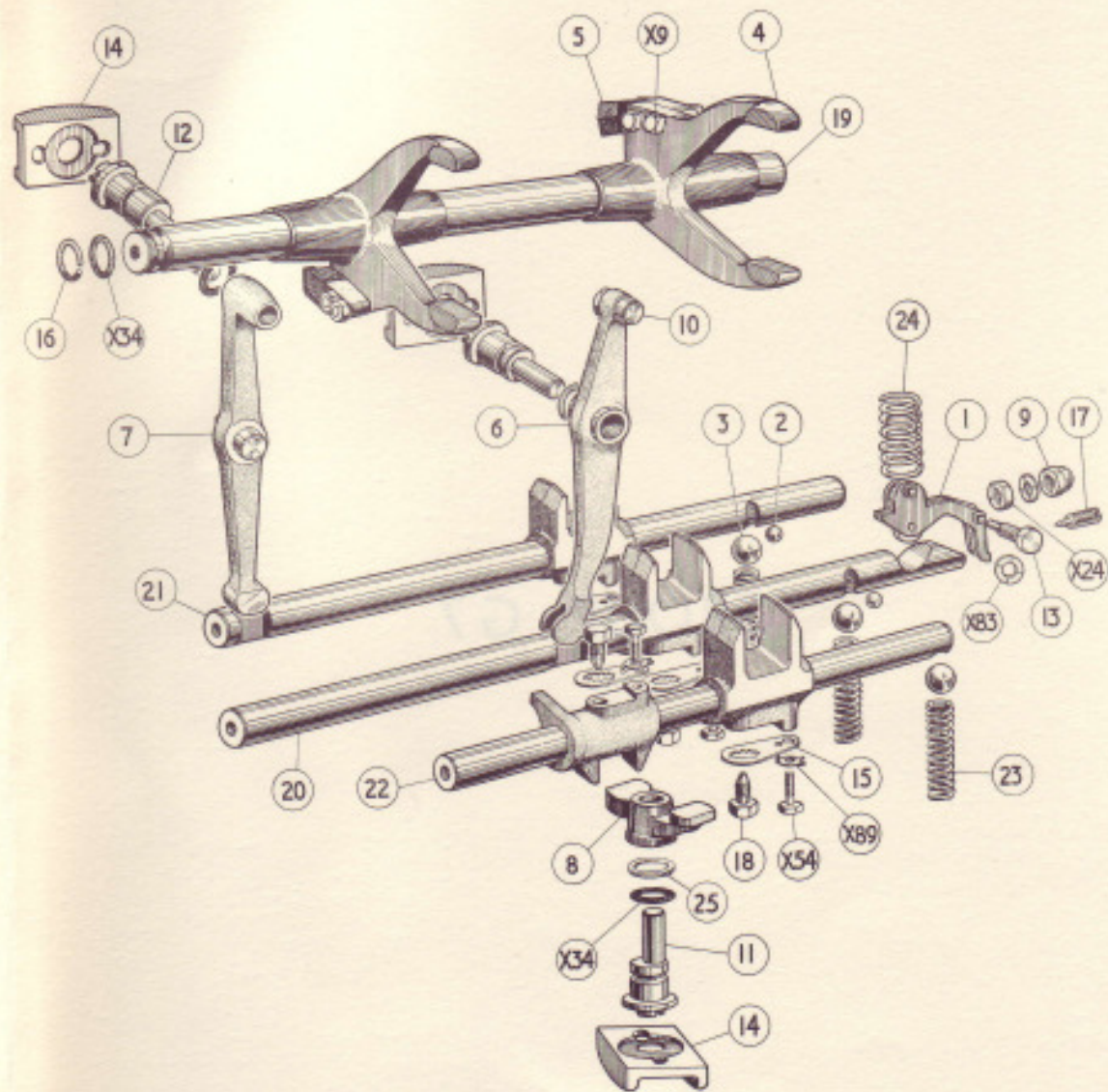

GROUP G 7

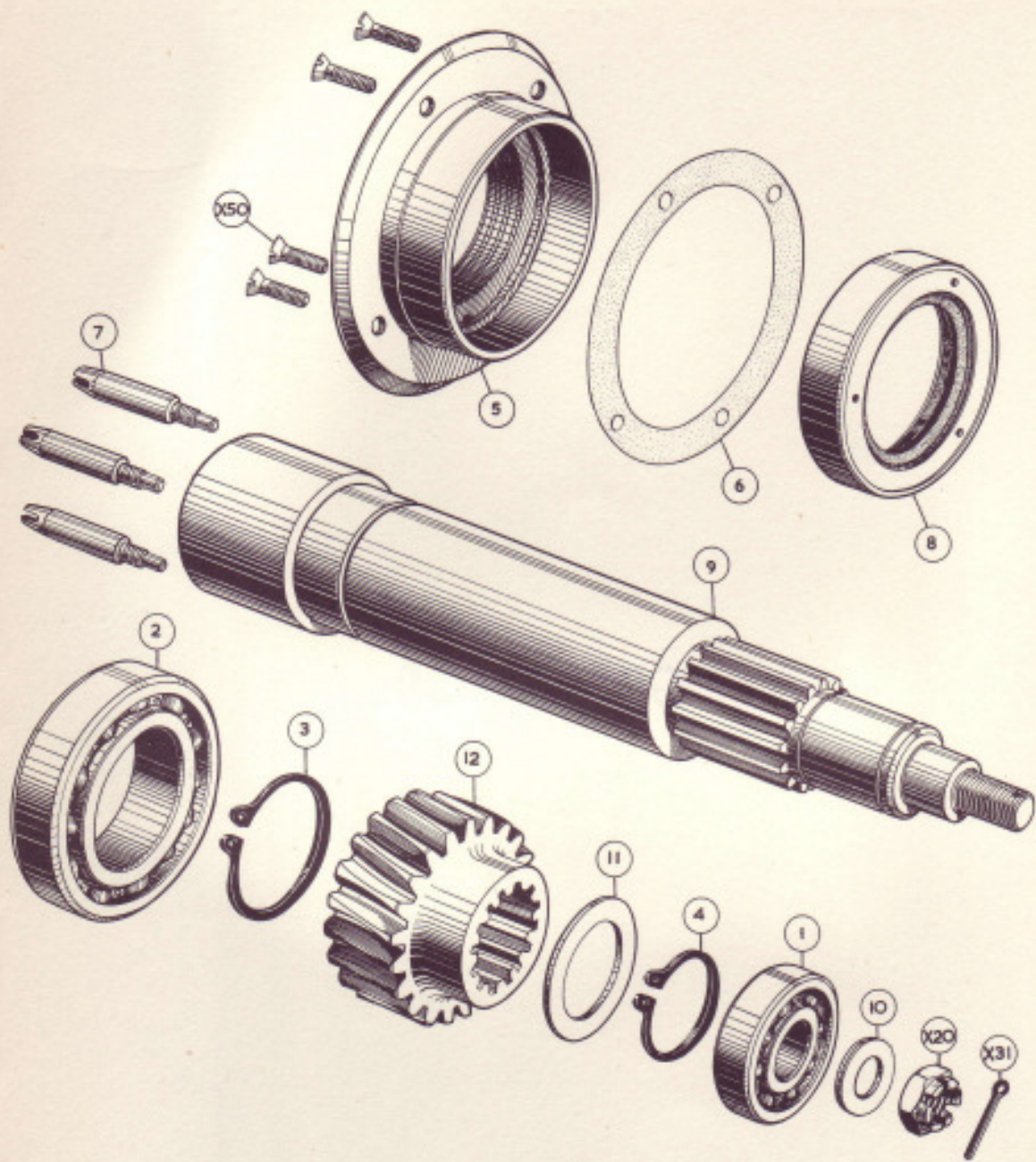

GROUP G 8

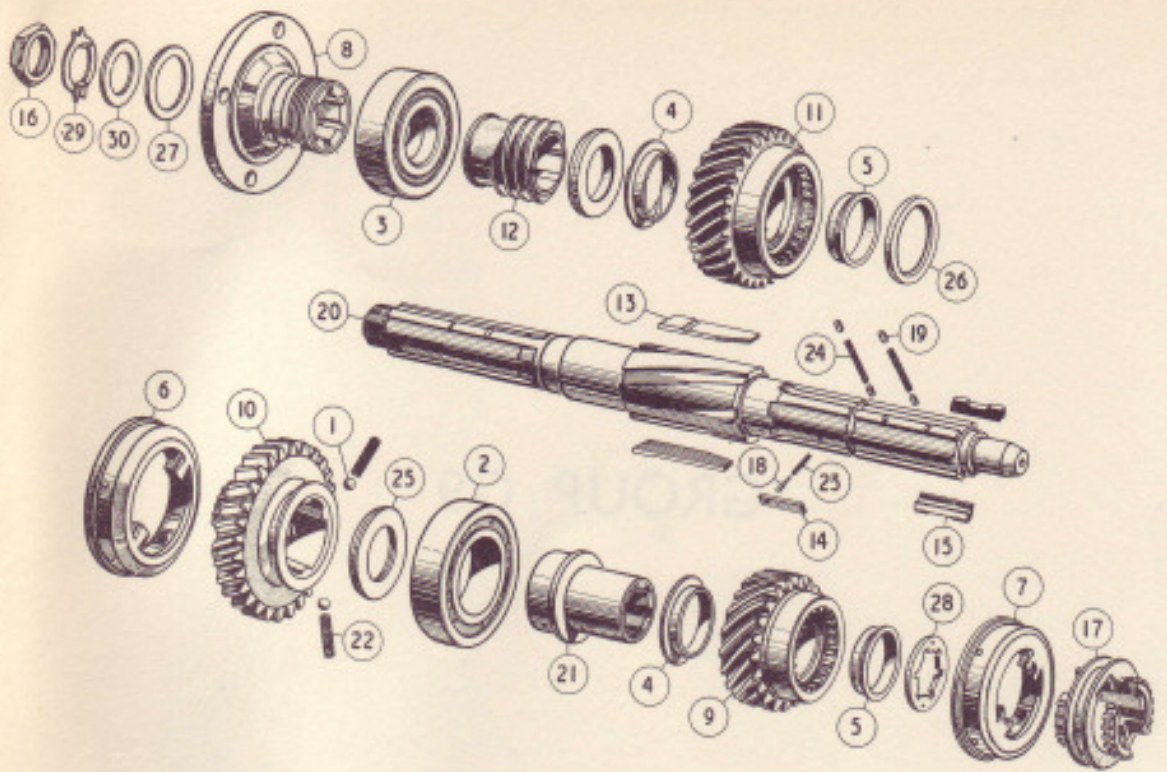

GROUP G9

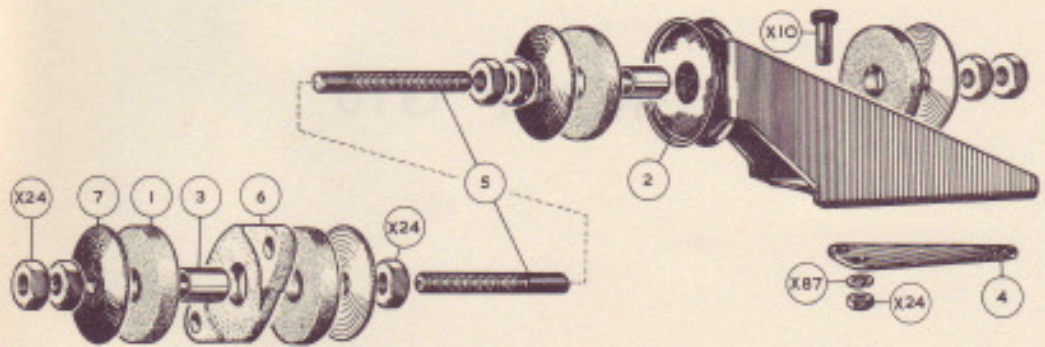

GROUP G10